

Reflective foil overlap

Sisalation® Foam Cell Resi Liner, Shed Liner, Multipurpose and Multipurpose LT are all supplied with a 150mm reflective foil overlap, commonly referred to as the 'lap', along one side edge to:

- Maximise coverage
- Reduce wastage
- Improve aesthetics in exposed applications
- Minimise taping of joints
- Allow for sealed edge protection
- Save you money!

The overlap incorporated means you don't waste material using it for coverage and overlap at joints. The 30m² rolls provides 30m² of coverage plus you have the benefit of the incorporated overlap. This means there is an additional 10% coverage in every roll, saving you time and money and giving you the confidence that joins provide a seal to keep condensation at bay.



150mm overlap along one side for more efficient installation

Looking for a thermal break solution?

In steel framed wall and roof construction, it is a requirement of the NCC to use a thermal break to reduce thermal bridging. An R0.2 thermal break is required between the steel frame and the wall cladding as well as between the steel frame and the metal roof.

Using Sisalation® Foam Cell 8.4mm products meets or exceeds the NCC requirements when used as a thermal break in steel framed construction, making both Sisalation® Foam Cell Multipurpose and Sisalation® Multipurpose LT 3-in-1 solutions.

THERMAL BREAK



Climate zone suitability

Knowing your climate zone is crucial to selecting the best Sisalation® product for your project. Use the map (right) to determine your climate zone, then check the tables below to choose the best Sisalation® product for your location and wall or roof type.

Climate zone	Wall type	Product	
1 2 3 4 5 6 7 8	Shed		
1	Light weight cladding, double brick cavity, brick veneer or masonry	Sisalation® Foam Cell Multipurpose Sisalation® Foam Cell Resi Liner Sisalation® Foam Cell Shed Liner vapour and water barrier	
2 3 4 5	Double brick, brick veneer or masonry		
6 7 8	Commercial building only: double brick, brick veneer or masonry		
2 3 4 5	Light weight cladding (check with manufacturer)		
Climate zone	Roof type	Overlap required	Product
1 2 3 4 5 6 7	Metal roof	Yes	Sisalation® Foam Cell Resi Liner
		No	Sisalation® Foam Cell Multipurpose Sisalation® Bubble Cell
1 2 3 4 5 6 7	Tile roof	Yes, needs to be taped	Sisalation® Foam Cell Resi Liner
		No	Sisalation® Foam Cell Multipurpose Sisalation® Bubble Cell
1 2 3 4 5 6 7 8	Shed roof		Sisalation® Foam Cell Shed Liner vapour and water barrier
			Sisalation® Foam Cell Multipurpose

- Zone 1
- Zone 2
- Zone 3
- Zone 4
- Zone 5
- Zone 6
- Zone 7
- Zone 8

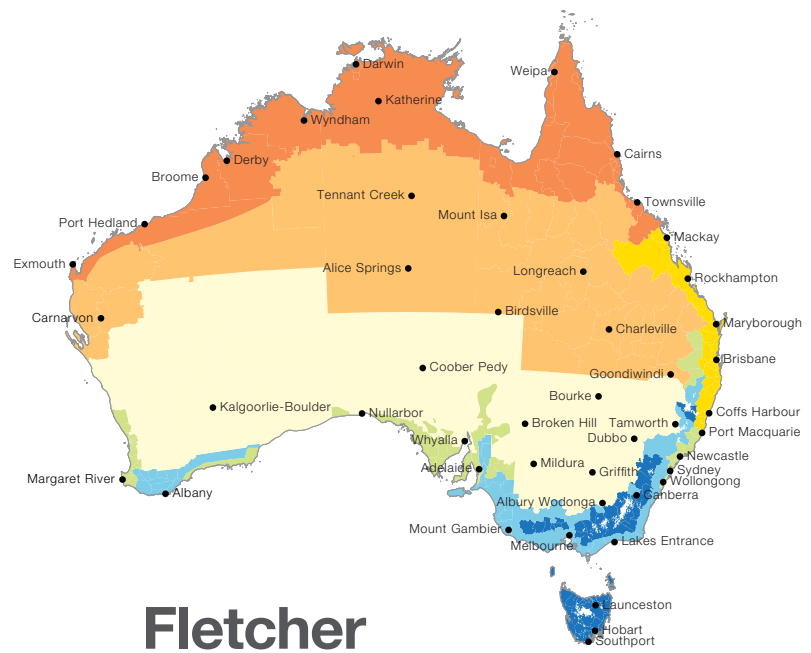

Fletcher Insulation
Building Better, Together

© Fletcher Insulation Pty Limited 2022. Fletcher Insulation reserves the right to change product specifications without prior notification. Information in this publication and otherwise supplied to users as to the subject product is based on our general experience and is given in good faith, but because of the many particular factors which are outside our knowledge and control and affect the use of products, no warranty is given or is to be implied with respect to either such information or the product itself, in particular the suitability of the product for any particular purpose. The purchaser should independently determine the suitability of the product for the intended application. The colour PINK, Pink® and Pink® Batts are registered trademarks of Owens Corning used under licence by Fletcher Insulation. FBS-1 Glasswool Bio-Soluble Insulation® is a registered trademark of ICANZ. Unless otherwise stated all ™ and ® are trademarks and registered trademarks of Fletcher Insulation Pty Limited ABN 72 001 175 355. BR035_Revision_2_Issue Date 17102022.

Customer Service Phone
1300 654 444
Email: info@insulation.com.au
www.insulation.com.au

Fletcher Insulation
Building Better, Together

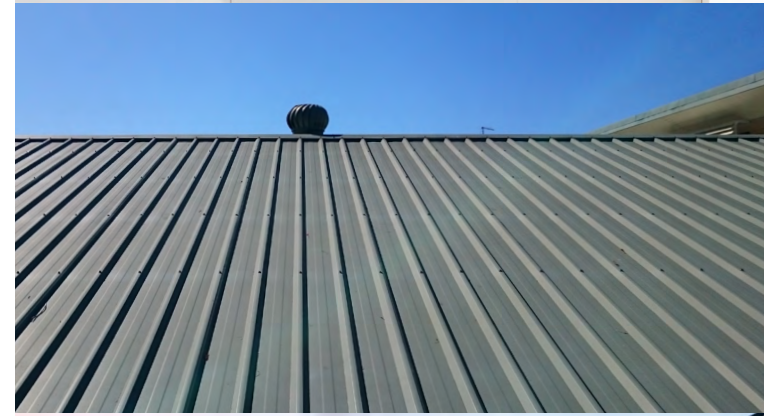

Sisalation® Foam Cell and Bubble Cell Sarking solutions range

sisalation
PROTECTS YOUR BUILD

Sisalation® Foam Cell and Bubble Cell sarking solutions is a range of high quality reflective insulation products which are suitable for use in a vast array of residential and commercial applications.

Sisalation® Foam Cell Resi Liner (5mm) for residential wall and roof applications where an overlap in installation is required

- 150mm reflective foil overlap.
- Suitable for use as a pliable building membrane and underlay in residential applications.
- Advanced thermal performance reflects up to 95% radiant heat, allowing for cooler internal conditions in hot and humid climates.
- Provides an effective vapour barrier.
- Suitable in roofs with a Bushfire Attack Level (BAL) of 12.5–40 and walls with a BAL of 12.5–FZ in accordance with AS 3959.
- Maximum durability and increased tear resistance.
- Aids in the prevention of condensation.
- Allows for easy and rapid installation.
- Incorporates an anti-glare coating on one side for added install safety.

Sisalation® Foam Cell Shed Liner (4mm) for use in sheds with metal framing and metal walls/roofs where an overlap in installation is required

- 150mm reflective foil overlap.
- Advanced thermal performance reflects up to 95% radiant heat, allowing for cooler internal conditions in hot and humid climates.
- Suitable for general purpose buildings such as sheds and workshops.
- Rated as Extra Heavy Duty (EHD), providing maximum strength and durability.
- Aids in the prevention of condensation.
- Minimal foam memory allowing for easy and rapid installation.
- Incorporates an anti-glare coating on one side for added install safety.

Sisalation® Foam Cell Multipurpose (8.4mm) for residential and commercial applications where an overlap in installation is required

- 150mm reflective foil overlap.
- Achieves a Group 2 Fire Rating suitable for use as an exposed wall or ceiling lining in commercial applications.
- 3-in-1 multipurpose solution: insulation + thermal break + vapour barrier.
- Advanced thermal performance reflects up to 95% radiant heat, allowing for cooler internal conditions in hot and humid climates.
- Allows for easy and rapid installation.
- Suitable for use as a thermal break for steel framed constructions in accordance with NCC requirements.
- Appropriate for use in a range of commercial and residential building applications.
- Suitable in roofs with a Bushfire Attack Level (BAL) of 12.5–40 and walls with a BAL of 12.5–FZ in accordance with AS 3959.
- Maximum durability and increased tear resistance.
- Aids in the prevention of condensation.
- Incorporates an anti-glare coating on one side for install safety.



Sisalation® Foam Cell Multipurpose LT (8.4mm) for residential and light commercial applications where a fire rated group number is not essential, and an overlap in installation is required

- 150mm reflective foil overlap.
- 3-in-1 multipurpose solution: insulation + thermal break + vapour barrier.
- Advanced thermal performance reflects up to 95% radiant heat, allowing for cooler internal conditions in hot and humid climates.
- Suitable for use as a thermal break for steel framed constructions in accordance with NCC requirements.
- Appropriate for use in residential and certain commercial applications where a fire rated Group Number is not essential.
- Suitable in roofs with a Bushfire Attack Level (BAL) of 12.5–40 and walls with a BAL of 12.5–FZ in accordance with AS 3959.
- Maximum durability and increased tear resistance.
- Aids in the prevention of condensation.
- Allows for easy and rapid installation.
- Incorporates an anti-glare coating on one side for install safety.

Sisalation® Bubble Cell (4mm) for residential wall and roof applications where NO overlap in installation is required

- Advanced thermal performance reflects up to 95% radiant heat, allowing for cooler internal conditions in hot and humid climates.
- Provides an effective vapour barrier.
- Suitable for use as a pliable building membrane and underlay in residential applications.
- Aids in the prevention of condensation.
- Suitable for use in roofs with a Bushfire Attack Level (BAL) of 12.5–40 and walls with a BAL of 12.5–FZ in accordance with AS 3959.
- Maximum durability and increased tear resistance.
- Allows for easy and rapid installation.
- Incorporates an anti-glare coating on one side for added install safety.

Note: Under AS4200 (part 2) 2017, clause 3.71, this product is to be butt-joined and taped when installed.

Product data

Property	Unit	Result
Thickness	mm	5
Width	mm	1350
Overlap/flap	mm	150
Length	m	22.25
Area per roll	m²	30
Weight per roll	kg	14
Product code		395266

Property	Unit	Result
Thickness	mm	4
Width	mm	1350
Overlap/flap	mm	150
Length	m	22.25
Area per roll	m²	30
Weight per roll	kg	11.5
Product code		395262

Property	Unit	Result
Thickness	mm	8.4
Width	mm	1350
Overlap/flap	mm	150
Length	m	22.25
Area per roll	m²	30
Weight per roll	kg	14
Product code		395264

Property	Unit	Result
Thickness	mm	8.4
Width	mm	1350
Overlap/flap	mm	150
Length	m	22.25
Area per roll	m²	30
Weight per roll	kg	14
Product code		395273

Property	Unit	Result
Thickness	mm	4
Width	mm	1350
Length	m	22.25
Area per roll	m²	30
Weight per roll	kg	14
Product code		395215

Physical properties

Property	Test Method/Standard	Results
Thermal Resistance R-value (m²K/W)	AS/NZS 4859.1	R0.11
Flammability Index	AS 1530.2	≤5 (Low)
Vapour Control	AS/NZS 4200.1	Class 1 Vapour Barrier
Water Control	AS/NZS 4201.4	Water Barrier
Emittance (reflective face)	AS/NZS 4201.5	IR Reflective (0.03)
Emittance (anti-glare face)	AS/NZS 4201.5	IR Semi-reflective (0.06)
Duty Classification	AS/NZS 4200.1 Table 1	Extra Heavy

Property	Test Method/Standard	Results
Thermal Resistance R-value (m²K/W)	AS/NZS 4859.1	R0.1
Flammability Index	AS 1530.2	≤5 (Low)
Vapour Control	AS/NZS 4200.1	Class 1 Vapour Barrier
Water Control	AS/NZS 4201.4	Water Barrier
Emittance (reflective face)	AS/NZS 4201.5	IR Reflective (0.03)
Emittance (anti-glare face)	AS/NZS 4201.5	IR Semi-reflective (0.06)
Duty Classification	AS/NZS 4200.1 Table 1	Extra Heavy

Property	Test Method/Standard	Results
Thermal Resistance R-value (m²K/W)	ASTM C518	R0.25
Group Number	AS 5637	2
Flammability Index	AS 1530.2	≤5 (Low)
Early Fire Hazard Indices	AS/NZS 1530.3	Complies
Vapour Control	AS/NZS 4200.1	Class 1 Vapour Barrier
Water Control	AS/NZS 4201.4	Water Barrier
Emittance (reflective face)	AS/NZS 4201.5	IR Reflective (0.03)
Emittance (anti-glare face)	AS/NZS 4201.5	IR Semi-reflective (0.06)
Duty Classification	AS/NZS 4200.1 Table 1	Extra Heavy

Application: Sisalation® Foam Cell Resi Liner Technical Specification

Residential stud walls, double brick cavities, under floors, sub floors and under tile and metal roofs.

Product composition (5mm thickness)

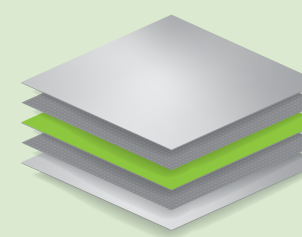

The insulation shall be **Sisalation® Foam Cell Resi Liner** with a material R-value of R0.11, Flammability Index of ≤5 and an Extra Heavy Duty rating in accordance with AS/NZS 4200.1. The insulation shall incorporate a 150mm wide overlap along one side length.

- Layer 1** Aluminium foil with anti-glare coating for 95% reflectivity
- Layer 2** High density polyethylene weave for EHD strength
- Layer 3** Polyethylene cross linked foam cell core
- Layer 4** High density polyethylene weave for EHD strength
- Layer 5** Aluminium foil with anti-glare coating for 97% reflectivity

Application: Sisalation® Foam Cell Shed Liner Technical Specification

Shed roofs and walls.

Product composition (4mm thickness)

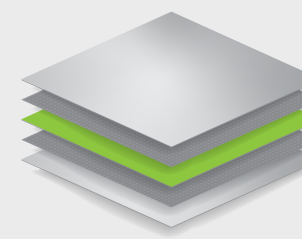

The insulation shall be **Sisalation® Foam Cell Shed Liner** 1350mm x _____m (insert length 22.25m or 33.44m) with a material R-value of R0.1, Flammability Index of ≤5 and an Extra Heavy Duty rating in accordance with AS/NZS 4200.1. The insulation shall incorporate a 150mm wide overlap along one side length.

- Layer 1** Aluminium foil with anti-glare coating for 95% reflectivity
- Layer 2** High density polyethylene weave for EHD strength
- Layer 3** Polyethylene cross linked foam cell core
- Layer 4** High density polyethylene weave for EHD strength
- Layer 5** Aluminium foil with anti-glare coating for 97% reflectivity

Application: Sisalation® Foam Cell Multipurpose Technical Specification

Steel frames in commercial and residential wall and roof construction as well as timber framed roof construction, where a Group Number 2 fire rating is required.

Product composition (8.4mm thickness)

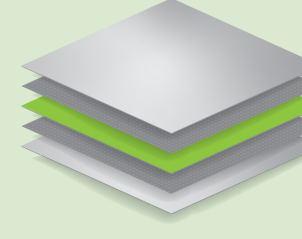

The insulation shall be **Sisalation® Foam Cell Multipurpose** with a material R-value of R0.25, Flammability Index of ≤5 and an Extra Heavy Duty rating in accordance with AS/NZS 4200.1 where a Group Number is required for compliance. The insulation shall incorporate a 150mm wide overlap along one side length.

- Layer 1** Aluminium foil with anti-glare coating for 95% reflectivity
- Layer 2** High density polyethylene weave for EHD strength
- Layer 3** Polyethylene cross linked foam cell core
- Layer 4** High density polyethylene weave for EHD strength
- Layer 5** Aluminium foil with anti-glare coating for 97% reflectivity

Application: Sisalation® Foam Cell Multipurpose LT Technical Specification

Steel frames in residential and certain commercial wall and roof construction as well as timber framed roof construction, where a Group Number fire rating is not required.

Product composition (8.4mm thickness)

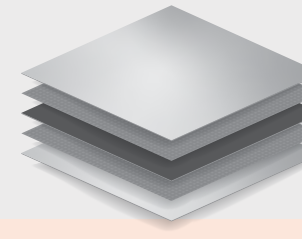

The insulation shall be **Sisalation® Foam Cell Multipurpose LT** with a material R-value of R0.2, Flammability Index of ≤5 and an Extra Heavy Duty rating in accordance with AS/NZS 4200.1 where a Group Number is not required for compliance. The insulation shall incorporate a 150mm wide overlap along one side length.

- Layer 1** Aluminium foil with anti-glare coating for 95% reflectivity
- Layer 2** High density polyethylene weave for EHD strength
- Layer 3** Polyethylene cross linked foam cell core
- Layer 4** High density polyethylene weave for EHD strength
- Layer 5** Aluminium foil with anti-glare coating for 97% reflectivity

Application: Sisalation® Bubble Cell Technical Specification

Residential stud walls, double brick cavities, under tile and metal roofs.

Product composition (4mm thickness)

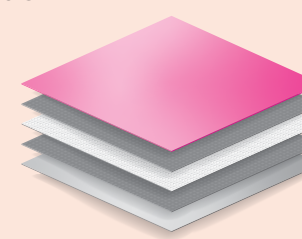

The insulation shall be **Sisalation® Bubble Cell** with a material R-value of R0.1, Flammability Index of ≤5 and an Extra Heavy Duty rating in accordance with AS/NZS 4200.1.

- Layer 1** Aluminium foil with anti-glare coating for 95% reflectivity
- Layer 2** High density polyethylene weave for EHD strength
- Layer 3** Triple layer of polyethylene bubble core
- Layer 4** High density polyethylene weave for EHD strength
- Layer 5** Aluminium foil with anti-glare coating for 95% reflectivity

WHERE AN OVERLAP IS REQUIRED

NO OVERLAP